

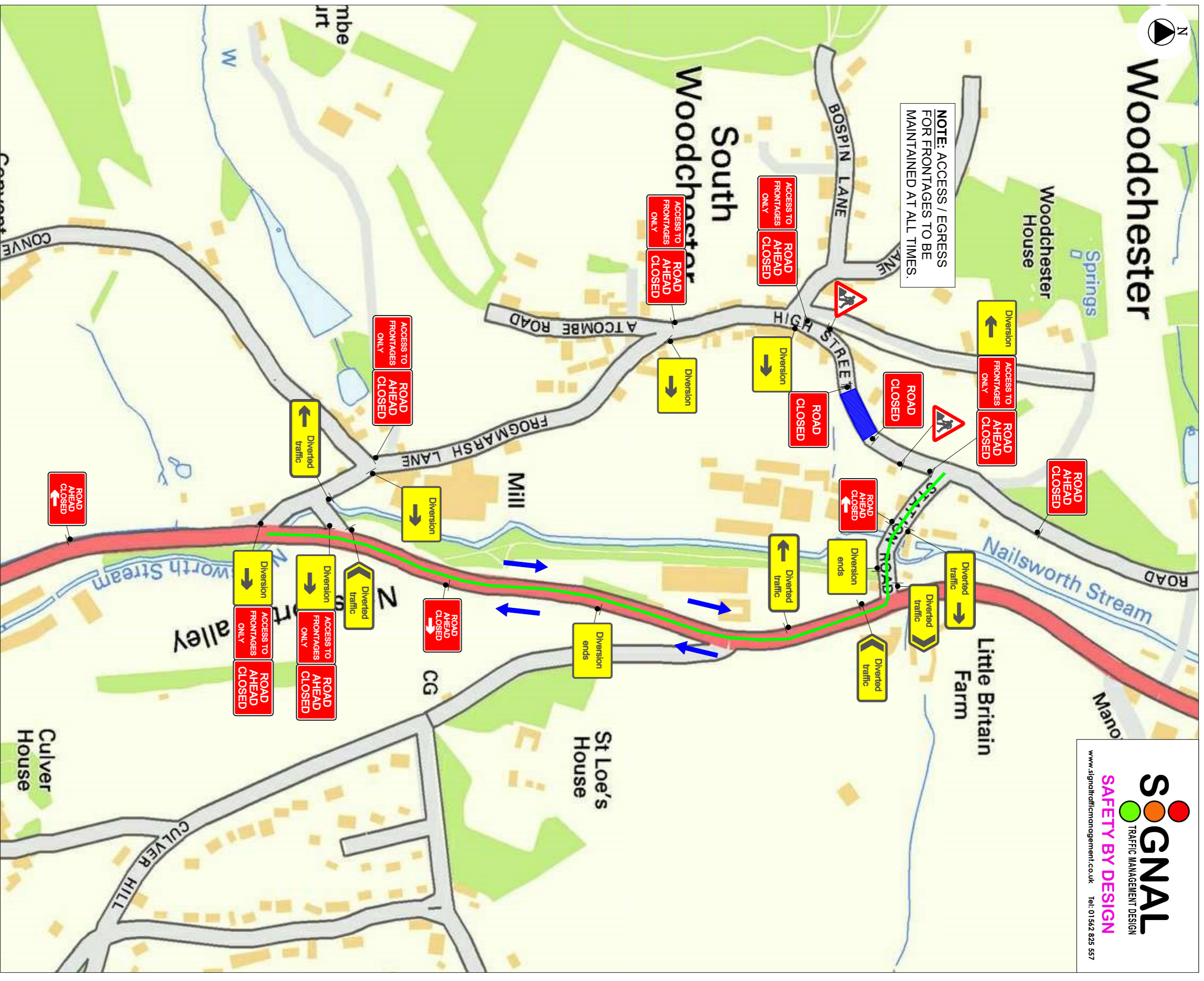

# Woodchester



### NOTES

- TRAFFIC SIGN
- TRAFFIC CONE
- ▨ WORK AREA
- ↔ DIVERSION
- DIVERSION ROUTE
- ⊕ TEMPORARY TRAFFIC SIGNAL
- ⊙ STOP/GO BOARD
- ⊙ EXISTING BUS STOP
- ⊙ PEDESTRIAN BARRIER
- ⊙ HERAS FENCING

### DENVERS - STATION ROAD

Speed of road(s) 30 MPH	
Minimum Sideways safety zone 0.5 M (min)	
Minimum Longways safety zone 0.5 M (min)	

### DIVERSION ROUTE

CLOCKWISE: STATION ROAD, A46 BATH ROAD
ANTI CLOCKWISE: A46 BATH ROAD, STATION ROAD
TOTAL NUMBER OF SIGNS: <b>34</b>

### CLIENT:



SITE: Station Road, Stroud, Gloucestershire, GL5 5EQ	
GRD REF: 383991 ; 202214	
TITLE: - 12431869 - Road Closure	
SCALE AT A3:	DATE:
NIS	01/05/2020
PROJECT NO:	DRAWING NO:
STM 31104	001
	REVISION:
	-